

FITZ PARK AND HOPE PARK CHARITABLE TRUSTS

Council Offices
50 Main Street
Keswick
CA12 5JS

Email: townclerk@keswicktowncouncil.gov.uk

3 July 2025

A meeting of the Charitable Trusts listed below will be held at the Quakers Meeting House, Elliot Park, Keswick on **Thursday 10th July 2025 at 7.00 pm.**

Yours sincerely



Vivien Little
Trust Clerk

HOPE PARK Registered Charity 503465
FITZ PARK Registered Charity 520327

A G E N D A

- 1. Apologies**
To receive apologies for absence.
- 2. Minutes**
To approve and authorise the Chair to sign the Minutes of the meeting held on 22nd May 2025 (pages 1-3).
- 3. Declarations of Interests**
To receive any declarations of interests in respect of items on this agenda.
- 4. Trustee Reports and Accounts for the year ended 31st March 2025**
To formally approve the Trustee Reports and Accounts for the year ended 31st March 2025 for Hope Park, Fitz Park and the Townsfield (to follow). Frances Clark of Keswick Accountants will be in attendance for this item.
- 5. Request to Display Banner**
To receive a request to display a banner at Hope Park from the Alhambra Cinema. A representative of the Alhambra Cinema will be in attendance for this item.
- 6. Chair's Report**
To receive the Chair's verbal report.
- 7. Parks Manager's Report**
To receive the report of the Parks Manager for July 2025.
- 8. Clerk's Report**
To receive the Trust Clerk's report.
- 9. Assets Register**
To approve and adopt the updated Assets Registers for Hope and Fitz Parks.

10. Futures Plans discussion – Expression of Interest

To receive a plan from Councillor Harwood (to follow). This is regarding a potential expression of interest in creating a new recreational use for Fitz Park next to Keswick Hospital.

Prior to the following business the Chair will move the following resolution:

‘That under the Public Bodies (Admission to Meetings) Act 1960, the public and representatives of the press and broadcast media be excluded from the meeting during the consideration of the following items of business as publicity would be prejudicial to the public interest because of the confidential nature of the business to be transacted.’

11. Lower Fitz Park River retaining wall

To receive the report of the Parks Manager.

To: All Councillors/Trustees
Press

FITZ PARK, HOPE PARK & TOWNSFIELD CHARITABLE TRUSTS

Minutes of the annual meeting of Charitable Trusts listed below held at the Cricket Club, Lower Fitz Park, Keswick Thursday 22nd May 2025 at 7.00 pm.

Present:

Chair
Councillor Jean Murray

	Councillors	
Louise Dunn	Natalie Evans	Steve Harwood
Denstone Kemp	Benita Lapthorn	Claire Peat

Also present were Vivien Little (Trust Clerk), Catherine Parker (Finance Officer) and Christine Fawcett (Parks Manager).

1. Election of Chair

There being only one nomination it was **RESOLVED** that Councillor Murray be elected as Chair for the ensuing year.

2. Election of Vice Chair

There being only one nomination it was **RESOLVED** that Councillor Chris Houghton be elected as Vice Chair for the ensuing year

3. Apologies

Apologies for absence were received from Councillors Chris Houghton, Claire Houghton, Nelson, Taylor and Scott.

4. Minutes

RESOLVED that the Chair be authorised to sign the Minutes of the meeting held on 13th March 2025 (pages 11-12).

5. Declarations of Interests

Councillor Harwood gave a personal explanation in regard to agenda item 14 as he was a member of Keswick Athletics Club. He would remain in the room and vote on the item.

6. Chair's Report

RECEIVED the Annual Report of the Chair of the Trusts.

RESOLVED that outreach be made to the Head of Keswick School, in order to work with the school to help teach healthy respect for the workings of the park (Action – Clerk).

7. Parks Manager's Report

RECEIVED the report of the Parks Manager. The Parks Manager updated Trustees on the issues caused by the extended run of dry weather, with it being difficult to put out plants, and the wood in the play area obviously drying out due to its age.

An issue with the self closer on the pedestrian gate into the play area was highlighted, and the Parks Manager stated that she would take a look at it (Action – Parks Manager).

8. Clerk's Report

RECEIVED the report of the Trust Clerk.

A query was raised whether the any proposed drainage work was actually in an area covered by the lease to the Football Club, or whether they were using the land informally. The Clerk stated that she would check into this and bring it back to the next meeting (Action – Clerk).

RESOLVED that the Biobliz event go ahead on 27 June 2025 in Elizabeth's Wood (Action – Clerk).

9. Futures Plans

RECEIVED the report of the Trust Clerk. The Futures Plans were looked at in some depth, with Trustees making suggestions to look at. One of the key things highlighted was the rotting river wall by Silver Bridge, and it was requested to ask the National Park/Environment Agency what materials were suitable and to look at costings to bring back to a future meeting, so that it can begin to be costed for (Action – Parks Manager, Clerk, Financial Officer). The Clerk was also requested to contact those who regularly put banners on our railings without permission and ask that these be removed (Action – Clerk).

RESOLVED that the Futures Plans be agreed, and be brought back annually at the May Trust meeting.

10. Linked Charities update

Trustees were asked to consider correspondence from the Charity Commission regarding the linking of Fitz Park and Townsfield Charities.

RESOLVED that the correspondence was noted.

11. Bowling Club – Proposed storage

RECEIVED the report from the Clerk. Trustees agreed with the idea of a building beside the Bowling Bower, with the cladding to match the Bower's exterior. They requested to also move their current small container to the other side of the Bower, to allow them to continue having that storage. It was felt that as the reason for the building was to ensure that all containers were gone, this would have to apply to the Bowling Club as well. The Clerk was also asked to ensure that the Bowling Club would be paying for their container to be removed, as well as obtain a timescale. (Action – Clerk).

RESOLVED that the proposal for a new building by the Bowling Club was agreed in principle, and that the request to site a container on the other side of the Bowling Bower be denied.

12. Budget Comparisons

RECEIVED budget comparisons for the fourth quarter.

13. Review of Hire Charges

RESOLVED that there would be no change to the fees for 2025/2026.

14. Requests for use of the Parks

Consideration was given to the requests to use the parks:

RESOLVED that

- i) Keswick Beer Festival were given permission to put banners on Fitz and Hope Park railings advertising the Beer Festival, to be removed by Sunday 8 June 2025 (Action – Clerk); and
- ii) Keswick Athletics Club, to host a barbecue for an after race social event at the Cricket Pavillion, in connection with the Round Latrigg race on Wednesday 11 June 2025 (Action – Councillor Harwood).

Prior to the following business the Chairman moved the following resolution:

'That under the Public Bodies (Admission to Meetings) Act 1960, the public and representatives of the press and broadcast media be excluded from the meeting during the consideration of the following items of business as publicity would be prejudicial to the public interest because of the confidential nature of the business to be transacted.'

15. Minutes

RESOLVED that the Chair be authorised to sign the Minutes of the meeting held on 6th May 2025 (pages 13-14).

16. Fitz Park update

RECEIVED the report of the Parks Manager.

RESOLVED that

- i) the Clerk lodge a complaint with the provider (Action – Clerk); and
- ii) £6,000 provision be taken from accruals to pay for the bill (Action – Financial Officer)

17. Deed of Easement

RECEIVED a report from the Clerk.

RESOLVED that a letter be sent as directed in the report. (Action – Clerk).

The meeting closed at 8.22 pm.

Chair

Date

Parks Manager Report July 2025**Christine Fawcett**

The weather over the last two months has been dry for the most of May and wet and warm in June. We were ready for the rain in late May as we nearly got to the low tide mark in the lake set back in 2019.

Thanks must go to the parks staff for their hard work and commitment and also to the three ladies from the office for their energy and support.

Hope Park

The summer bedding has all been planted out and is growing nicely to provide a colourful display that includes geraniums and Canas.

Half term week was very busy within both parks and trade waste collections had to be increased to accommodate the volume of litter.

The pitch and putt is looking well given the dry spell and all the play it is experiencing. All of the putting greens have been treated with liquid iron to improve root growth and plant health. An application of summer fertilizer has been applied in late May and a further application will be given in July to withstand the footfall and aid recovery. The fairway by the seventh green has been chain harrowed to remove moss and improve drainage.

The wildflower beds have been sown between the 1st and 3rd Tee and is going to flower in the coming weeks. The woodland area is looking good with its own carpet of flora and fauna, although more ash trees are showing signs of ash die back. These trees are being monitored.



The Fairtrade border has been planted with mixed coloured fibrous begonias. These begonias will fill out of the summer months to provide a lovely display and heaven for wildlife. The centre of the bed is planted with herbaceous perennials including phlox, rebecca and miscanthus.

Lower Fitz Park



The small area next Knights bridge has been planted up with the remaining bedding plants to add a little colour to the area.

The car park surface has been sprayed twice this season and the hedge lightly trimmed at the base in early June. Hospital Field stream has been cleaned out by a local contractor, allowing water to run freely through the area.

The footpath through Elizabeths wood is being strimmed back on a regular basis to avoid it becoming overgrown with vegetation. It is however frustrating that people must remove railing on the fence line to create their own shortcut into the area.



Upper Fitz Park

Public games are now in operation most days through Café HNW. The tennis club is using the courts for both club matches and junior training sessions and play on the grass courts is popular.

Verti-cutting has been carried out across the bowling green and tennis courts to remove thatch. This will be carried out again in July as time allows. The ongoing repairs to the playing surfaces are carried out on a weekly basis to get the turf surface through the season.

Given the dry spell we had in May the grassed areas have recovered well. An



application of liquid iron and liquid seaweed has been applied to aid with disease and help keep the turf healthy.

Shrubs are being pruned and shaped and beds weeded on a regular basis to keep the park looking tidy and keep footpath clear. As with Hope Park half term was extremely busy with tourists and visitors.



A press release has been published by Dennis Mowers in the Landscape and Amenity Magazine regarding our three electric mowers. This is good publicity for the parks and shows our commitment to climate change. If you wish to read the article, please visit the link below.

Due Dennis ES-510 delivers electric performance

Keswick's two flagship parks – Hope Park and Fitz Park – nestled in the heart of the Lake District in Cumbria, are setting the standard for sustainable grounds maintenance thanks to the exceptional performance of three Dennis ES-510 battery-powered mowers.

The move to electric machinery was spearheaded by Christine Fawcett, Parks Manager at Keswick Town Council, following the council's bold step to declare a climate emergency.

"Keswick Town Council and Keswick Parks declared a climate emergency six years ago," Christine explains.

"So obviously things had to change with fossil fuelled maintenance machinery, and we started looking for battery alternatives."

The parks team had been long-time users of the petrol-powered Dennis FT510, known for its reliability and versatility – particularly its interchangeable cassette system.

When Dennis introduced the battery-powered ES-510, which retained compatibility with the same range of cassettes, the transition was a natural progression.

"We'd built up a full suite of cassettes over the years," says Christine. "From scarifiers to brushes, verticutters, sorrel roller and cutting cassettes – we rely on all of them throughout the year to deliver high standards of turf care."

"When the ES-510 came out, it looked like the perfect time to make the change to battery. And because the cassettes were compatible, we didn't need to start from scratch."

In fact, Keswick's parks team became the first users in the UK to adopt an electric Dennis machine three years ago and now operate three ES-510s across both Hope and Fitz Parks.

One ES-510 can handle a significant workload in a single day – cutting the bowling green, two grass-court tennis courts, and nine holes on the pitch and putt – with the battery lasting comfortably through the day.

Dennis Enquiry 6

A photograph showing a person operating a green Dennis ES-510 battery-powered mower on a large grassy field. The mower is a compact, walk-behind model. In the background, another person is visible, and the landscape features trees and a clear sky.

https://issuu.com/tspmedialtd/docs/landscape_product_update_june_2025

KESWICK PARKS CHARITABLE TRUSTS

10 July 2025

Clerk's Report

Update on Football Club Lease

Following the last Trust meeting, it was requested that I go back and check the Football Club lease to confirm if the Football Club did in fact lease the area where the proposed drainage work would go ahead, or if they were using the land informally.

Having checked the lease, I can confirm that it does form part of the formal lease (see plan attached), therefore any work there would have to be agreed to by ourselves as landlord, but I see no reason to deny them access should they wish to move forward with it.

Bowling Club storage

Following the decision to allow the Bowling Club permission to build a storage facility next to the Bower, Councillor Harwood has redrawn plans which would ensure that there was no need for a container to be retained beside the Bower. These plans are attached for approval.

I have requested an updated timeline from the Bowling Club, but as yet have not received it.

Vivien Little

1 July 2025

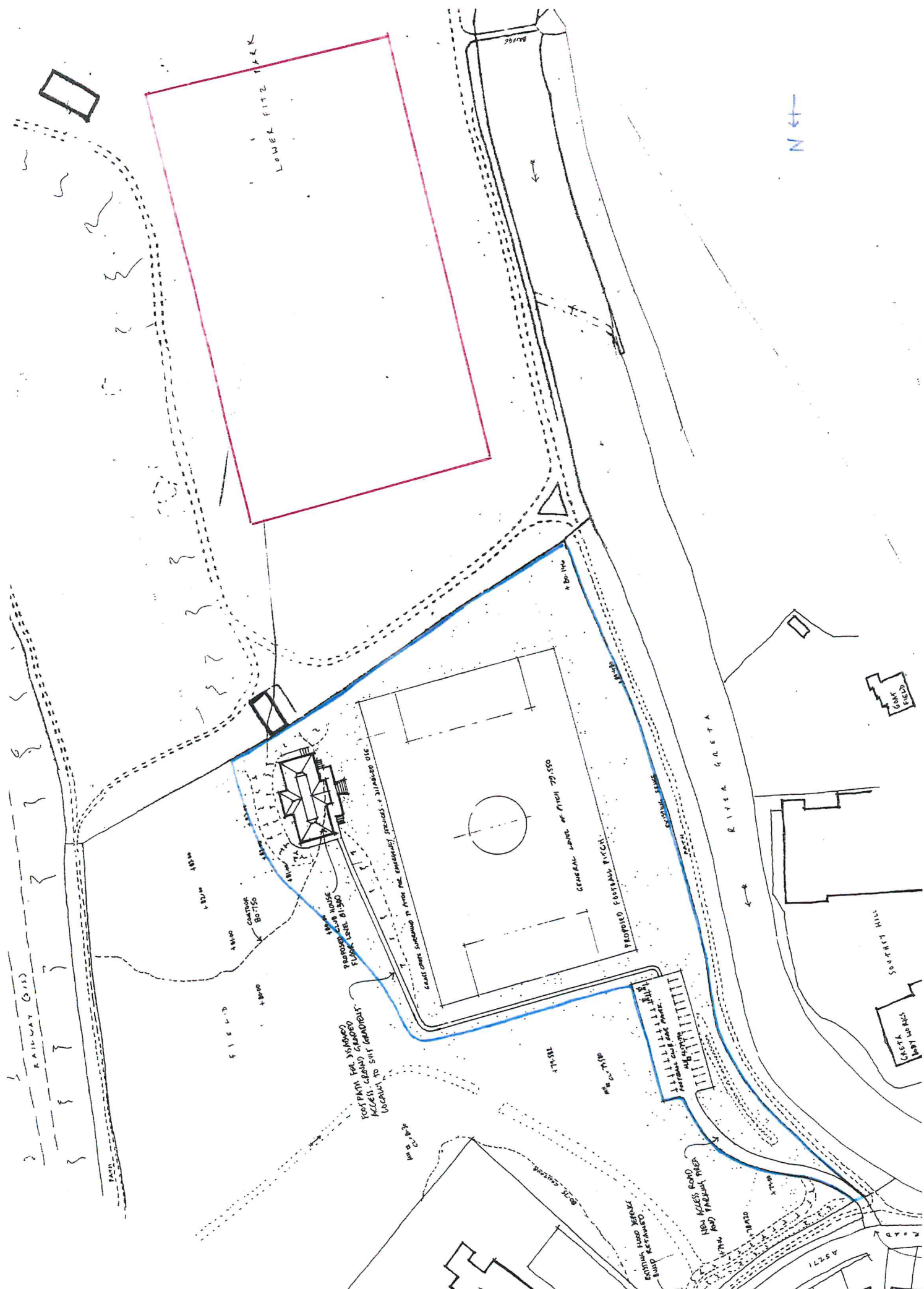

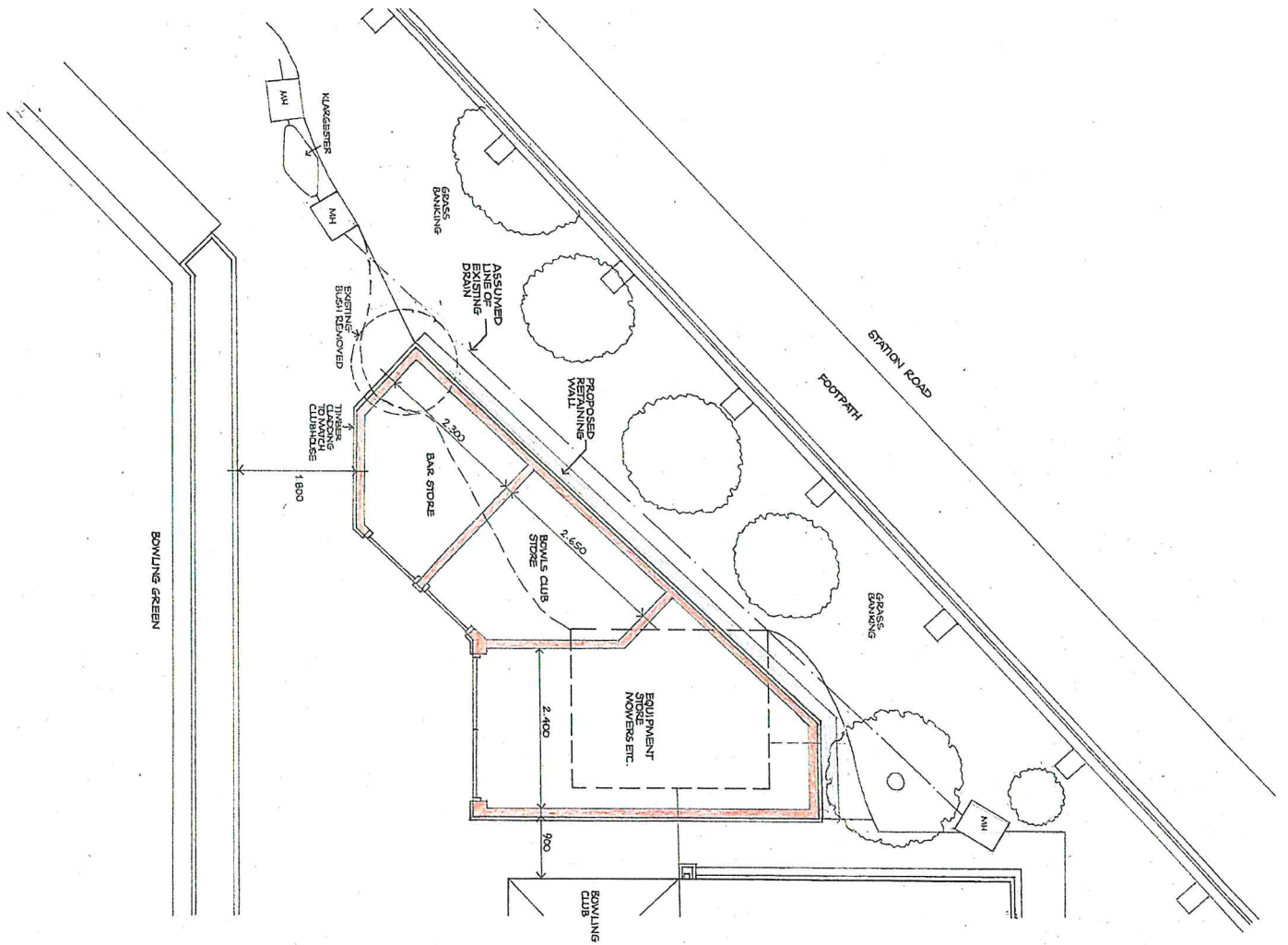

KESWICK TOWN COUNCIL ASSETS REGISTER

FITZ PARK CHARITABLE TRUST

AS AT 31/3/2025

NEW BUILD FITZ BUT FUNDED FROM HOPE (£110,000) & FITZ (£115,932)

Disposals as confirmed by Parks Manager - NONE

Date Purchased	Purchase Cost	Description	Location	Notes	Previous year's value	Additions	Disposals	Total	Depreciation @ 0%	Current Value	NOTES - For info
Land & Buildings		Sports Pavillion, Bowling Bower & Tennis Hut (Cafe HNW)	Fitz Park, Station Road	Original deeds held at Keswick Museum							
	225932	NEW BUILD - Staff Premises & Workshop			0	225932		225932		225932	
		Storage Buildings - 2 x container & 1 x staff unit									NOTE FOR NEXT YEAR - DISPOSED APRIL 2025
					190285			190285		190285	
					190285	225932		416217		416217	
Date Purchased	Purchase Cost	Description	Location	Notes	Previous year's value	Additions	Disposals	Total	Depreciation @ 20%	Current Value	
Trust Plant & Machinery (Parks & Staff Premises Equipment & Power Tools)											
31.03.13	E172.00	Chubb Safe	Games Hut		10				2	8	
27.02.15	E500.00	Transbank Fuel Store	Fitz Park	800 x 420 x 520	54				11	43	
30.09.15	E157.25	Husqvarna 435 15 bar chainsaw (50% Hope/Fitz)	Workshop Hope/Fitz	Ser 2014 1100006	22				4	18	
31.10.16	E389.00	Honda 2.75KVA Generator	Workshop Hope/Fitz	SP2500 GX160	66				13	53	
31.10.16	E269.00	Makita Compact Drill Driver	Workshop Hope/Fitz	DLX2005M	45				9	36	
31.10.16	E116.91	Milwaukee Orbit Sander 240V	Workshop Hope/Fitz	4933431180	19				4	15	
31.10.16	E47.63	Comb Spanner set MM (14)	Workshop Hope/Fitz	8-32mm	8				2	6	
31.10.16	E534.50	Belle Minimik 150 Cement Mixer	Workshop Hope/Fitz	866030	90				18	72	
26.11.16	E49.90	Makita Angle Grinder 240V	Workshop Hope/Fitz	GA4530	9				2	7	
06.01.17	E565.00	New Howardson Brush Cassette (to fit 510)	Workshop Hope/Fitz	11151163	95				19	76	
05.06.18	E204.16	Stihl FS56R C-E blower	Workshop Hope/Fitz	FS56R C-E	42				8	34	
22.05.19	E500.00	Dennis Scarifier Cassette - Hope charged E370 Total cost E870	Workshop Hope/Fitz	S/N 21484	131				26	105	
12.04.19	E125.19	Transbank Fuel Store - Yellow	Fitz Park	SBXTRBC1	33				7	26	
24.05.19	E169.95	Sealey Direct Drive Compressor SAC2420E	Fitz Park		56				11	45	
05.07.19	E217.21	Werner mastertrade stepladder	Fitz Park	7140818	71				14	57	
26.07.19	E200.00	Howardson Mower FT510 cylinder mower - Hope charged E3480 Total cost E4680	Workshop Hope/Fitz	FT203539	66				13	53	
08.08.19	E180.00	Husqvarna 122HD456 hedgecutter	Fitz Park	240096653/2301212	59				12	47	
07.02.20	E335.00	Makita Hammer drill SDS Max	Fitz Park	G1/71900091	110				22	88	
11.08.20	E1,190.00	Honda Pro Mower	Fitz Park	HM0670C	488				98	390	
08.01.21	E134.00	Makita cordless angle grinder	Fitz Park	MZBU-8709993	55				11	44	
03.09.21	E1,260.00	New Honda Self Propelled 21" Hydrostatic drive	Fitz Park	DGA4522	645				129	516	
1.10.22	E12,230.00	Dennis Electric mower (sinking fund) - Total cost E12,230 but used mower from Hope for part ex E1,000	Fitz Park	31193325	7827				1565	6262	
03.10.22	E235.00	AccuPro 200 Rotary seed/fertiliser spreader - Hope charged E400 Total cost E635	Workshop Hope/Fitz	ES100009/25760	150				30	120	
07.10.22	E470.00	Dennis Scarifier/verticuter cassette - Hope charged E800 Total cost E1,270	Fitz Park	Accupro 2000	25711	301			60	241	
23.03.23	E370.79	Makita circular saw and associated accessories - folding saw horses	Fitz Park	383RK, 83731, 738RK, 2721V & 83366	238				48	190	
31.05.23	E162.99	CP Evolution Knapsack Sprayer	Fitz Park	CPCP15/EV	130				26	104	
07.07.23	E282.00	Cordless Strimmer (brushcutter)	Fitz Park	444142031	226				45	181	
07.07.23	E162.00	Stihl Hedgeclimber - Hope charged E35 Total cost E197.00	Fitz Park	447471534	130				26	104	
09.01.24	E66.66	Makita battery	Fitz Park	2721V	54				11	43	
23.02.24	E149.99	Makita 18v combi drill	Fitz Park	412XT	120				24	96	
08.03.24	E570.00	New Howardson Brush Cassette (to fit 510) - Hope charged E370 Total cost E940	Fitz Park		453				91	362	
01.05.24	E108.33	Makita Site radio	Fitz Park	11216849	0	108			22	96	
01.03.24	E116.66	120bar pressure washer	Fitz Park	578PV	0	117			23	94	
10.10.24	E109.69	Makita Powarsaw - Hope charged E495.00 Total cost E604.69	Hope Park	610RK	0	110			22	88	
30.10.24	E380.00	New Echo backpack blower	Fitz Park	842EK6100	0	380			76	304	
05.12.24	E69.00	Makita combi drill - body only	Fitz Park	P55140004362	0	69			14	55	
10.03.25	E85.49	Makita combi drill - bare	Fitz Park	842DHP4822	0	85			17	68	
	E22,885.30				11803	869	0	12672	2534	10138	
Trust Plant & Machinery (Park Furniture)											
		Large wheelle bin	Allerdale Borough		0				0	0	
		Small wheelle bins x 4	Councils Property		0				0	0	
31.03.02	E1,289.00	Memorial seats			10				2	8	
2008/09	E540.00	Memorial seats			15				3	12	
2009/10	E640.00	Memorial seats			22				4	18	
26.03.10	E509.00	Standard Wooden Picnic Tables (Play Area)			14				3	11	
19.01.17	E753.75	Memorial seats			126				25	101	
15.02.17	E360.00	Memorial seats			60				12	48	
13.06.18	E1,040.10	Memorial seats (3)			218				44	174	
05.09.18	E1,020.00	Memorial seats (3)			214				43	171	
03.09.18	E450.00	Memorial seat (1)			118				24	94	
10.09.18	E400.00	Memorial seat (1)			105				21	84	
20.09.18	E450.00	Memorial seat (1)			118				24	94	
26.06.19	E450.00	Memorial seat (1)			147				29	118	
24.10.19	E215.00	Memorial seat (1)			70				14	56	
13.01.20	E310.00	Memorial seat (1)			101				20	81	
23.09.20	E355.00	Memorial seat (1)			146				29	117	
31.03.22	E1,650.00	Memorial seats during year (5)			846				169	677	
31.03.23	E1,605.00	Memorial seats during year (4)			1027				205	822	
31.03.24	E1,997.50	Memorial seats during year (5)			1600				320	1280	
31.03.25	E427.50	Memorial seats during year (1)			0	428			86	343	
	E14,461.85				4957	428	0	5385	1077	4308	
		Total Plant & Machinery		14446							
Office Equipment											
31.03.25 (Inv 25.04.25 - accrual)	639.83	HP Probook 440 G10 14" laptop	Fitz Park		0	630	0	630	126	504	
					0	630	0	630	126	504	
Playground Equipment											
31.12.09	E86,867.00	Various Items			5477				1095	4382	
					5477	0	0	5477	1095	4382	
Date Purchased	Purchase Cost	Description	Location	Notes	Previous year's value	Additions	Disposals	Total	Depreciation @ 0%	Current Value	
Car Park											
31.03.12	E 99,797.00	New Car Park - Hospital Field	Hospital Field		99797			99797		99797	
CSA											
31.03.11	E 136,213.00	New CSA	Lower Fitz Park		136213			136213		136213	
BMX Track											
18.03.14	E 36,600.00	New BMX Pump Track	Hospital Field		36600			36600		36600	

Disposals as confirmed by Parks Manager

Date Purchased	Purchase Cost	Disposals during year - Original Cost	Description	Location	Notes	Previous year's value	Additions	Disposals	Total	Depreciation @ 0%	Current Value
Land & Buildings											
			Greenhouse & Potting shed, Workshop (old), store, toilets	Hope Park, Lake Road	Original deeds held at Keswick Museum	66198			66198		66198
	£85,000		New Golf Hut (increased insurance value)	Hope Park, Lake Road		85000			85000		85000
	£178,198		New Café Hope (Funded by Hope Leisure)	Hope Park, Lake Road		178198			178198		178198
	£121,193		New Equipment Store & Staff Building (Sum Insured Value)	Hope Park, Lake Road		121193			121193		121193
						450589	0	0	450589	0	450589
Vehicles											
01.02.17	£18,500.00		Tractor PX66 ECZ - On Hire Purchase	Hope Park	S/N S18500G8PJ0018925	3104				621	2483
19.04.18	£2,560.00		Brian James Cargo Trailer	Workshop Hope/Fitz		670				134	536
20.01.23	£27,000.00		Ford Transit custom van BJ21UUY	Hope Park		17280				3456	13824
08.08.24	£22,000.00		Kubota RTV X1110 Utility Vehicle PY23 HHE	Fitz Park	W24TC00982	17600				3520	14080
	£70,060.00	£0.00				38654	0	0	38654	7731	30923
PLANT MACHINERY & EQUIPMENT											
Equipment & Power Tools											
17.01.08	£1,500.00		Horti Wessex 1 ton trailer	Hope Park	Serial No 078471	34				7	27
17.01.11	£3,049.00		Bannerman BA-4 Air/ject Aerator CT-H	Workshop Hope/Fitz	S/N 04-4283	134				27	107
21.01.14	£1,500.00		Container - Held at Fitz Park (from D & E Fund)	Fitz	n/a	129				26	103
27.02.15	£500.00		Transbank Fuel Store	Hope Park	800 x 420 x 520	54				11	43
30.09.15	£157.25		Husqvarna 435 15 bar chainsaw (50% Hope/Fitz)	Workshop Hope/Fitz	Ser 2014 1100006	22				4	18
20.04.16	£3,890.00	£3,890.00	Dennis F1430 Power Unit 5 blade unit mower	Hope Park	FT171793	651		651		0	0
20.04.16	£310.00		Echo Blower PB580	Workshop Hope/Fitz	37001850	52				10	42
20.04.16	£206.00		Echo CS-280WES -12" Chainsaw	Workshop Hope/Fitz	11146069	34				7	27
20.04.16	£128.00		Rochford Cooper Peglar 15L Classic Knapsack Sprayer	Workshop Hope/Fitz	11146068	22				4	18
08.06.16	£510.00		Echo Brushcutters SRM420TESU	Workshop Hope/Fitz	S/N 370045590	86				17	69
25.07.16	£725.00		SCH Supplies 180L Towed Sprayer	Workshop Hope/Fitz	GWCS9	122				24	98
25.02.17	£375.00		Husqvarna 346XP Chainsaw	Workshop Hope/Fitz	346XP	62				12	50
28.02.17	£94.70		HR2630 SDS + Hammer Drill 240V	Workshop Hope/Fitz	842HR2630/2	16				3	13
01.04.17	£4,650.00	£4,650.00	Iseki Ride on Mower SXG323	Workshop Hope/Fitz	SXG323100332	1636		1636		0	0
25.04.17	£209.37		Husqvarna S25LK Engine Unit	Workshop Hope/Fitz	20171100316	44				9	35
12.05.17	£128.90		SAC2420E 24L 2HP direct drive compressor	Workshop Hope/Fitz	SAC2420E	27				5	22
25.05.17	£145.75		Husqvarna 122HD45 Hedgecutter	Workshop Hope/Fitz	122HD45	30				6	24
20.06.17	£355.00		Trojan 30 Plus Fert Spreader	Workshop Hope/Fitz	74508	75				15	60
05.10.17	£193.75		Husqvarna HA850 combi hedge trimmer attachment	Workshop Hope/Fitz	537196606	40				8	32
06.04.18	£110.95		CP Evolution Knapsack Sprayer	Workshop Hope/Fitz	CPCP15EV	30				6	24
19.04.18	£788.00		2 x Echo SRM300TESU Brushcutters	Workshop Hope/Fitz	S/N 555737035564 & 555737035447	206				41	165
23.04.18	£3,500.00	£3,500.00	Breadwood International (Wessex Mower)	Workshop Hope/Fitz	S/N 170293	918		918		0	0
10.05.18	£90.83	£90.83	Lay Lithium Combi Drill	Workshop Hope/Fitz	DHP4535F	24		24		0	0
02.05.18	£370.00		Dennis Scarifier Cassette - Fitz charged £500 Total cost £870	Workshop Hope/Fitz	S/N 21484	98				20	78
21.03.19	£214.49		GYSM 160P 160 MMA Inverter Welder	Workshop Hope/Fitz	909G020	56				11	45
26.07.19	£3,480.00		Howardson Mower FT510 cylinder mower - Fitz charged £200 Total cost £4680	Workshop Hope/Fitz	FT203539	1141				228	913
10.06.20	£2,900.00		SHS Fast tow water bowser and honda pump	Workshop Hope	36053	1188				238	950
22.12.20	£650.00		Lifan 3600 psi pressure washer	Workshop Hope	SRB1/PV-0173	266				53	213
22.10.21	£434.55		Honda Generator	Workshop Hope	855HX3000	222				44	178
08.11.21	£613.03	£613.03	Stihl Backpack Blower	Workshop Hope	526632668	314		314		0	0
17.02.22	£171.35		Stihl battery operated Hedge trimmer	Workshop Hope/Fitz	444947959	88				18	70
28.06.22	£800.00		Dennis Scarifier/verticuter cassette - Fitz charged £470 Total cost £1,270	Workshop Hope/Fitz	25711	512				102	410
03.10.22	£400.00		AccuPro 200 Rotary seed/fertiliser spreader - Fitz charged £235 Total cost £635	Workshop Hope/Fitz	Accupro 2000	256				51	205
10.11.22	£1,000.00		Honda HRX537HY Lawnmower (HP)	Workshop Hope	MCGF1004970	640				128	512
15.12.22	£538.00		Stihl battery operated FSA90 strimmer	Workshop hope	446322647	344				69	275
07.07.23	£35.00		Stihl Hedge trimmer - Fitz charged £162 Total cost £197.00	Fitz Park	447471534	28				6	22
07.07.23	£162.00		AP300 Battery	Hope Park	916726522	130				26	104
05.10.23	£187.49		Samsung X cover 5, sim free and unlocked	Hope Office		150				30	120
09.11.23	£13,005.00		Howardson ES-510 electric mower, battery, grassbox (E10990), 10 blade cylinder E1215, battery charger E800	Workshop Hope	E5100022/27509/CV 0049	10403				2081	8322
20.11.23	£2,950.00		New Wessex tipping trailer	Hope Park	231549	2360				472	1888
28.11.23	£370.00		Echo PB580 backpack blower	Hope Park	P55140001779	295				59	236
08.03.24	£370.00		New Howardson Brush Cassette (to fit 510) - Fitz charged £570 Total cost £940	Fitz Park	11216849	295				59	236
05.04.24	£168.50		Numatic Henry Hoover	Hope Park	NRV240	0	169			34	135
28.05.24	£250.00		Stihl Strimmer	Hope Park	446966645	0	250			50	200
29.05.24	£186.35		SAS Wheel Clamp	Hope Park	ZWH-NDEF	0	187			37	150
06.09.24	£14,500.00		NEW Iseki Low Tip mower SXG324	Hope Park	11182520	0	14500			2900	11600
04.10.24	£12,940.00		NEW Howardson Dennis ES 510 mower (power unit)	Hope Park	E5100043	0	12940			2588	10352
10.10.24	£495.00		Makita Powersaw - Fitz charged £109.69 Total cost £604.69	Hope Park	842EK6100	0	495			99	396
	£80,298.26	£12,733.86				23234	28541	3543	48232	9646	38586
Furniture											
	£3,033.00		Seats (golf hut)	Hope Park		17				3	14
01.10.01	£1,834.00		Memorial seats	Hope Park		11				2	9
2002	£1,037.00		Memorial seats	Hope Park		10				2	8
2003/04	£3,814.00		Memorial seats	Hope Park		44				9	35
2004/05	£1,838.00		Memorial seats	Hope Park		27				5	22
2005/06	£472.00		Memorial seats	Hope Park		11				2	9
2008/09	£1,080.00		Memorial seats	Hope Park		30				6	24
2009/10	£1,919.00		Memorial seats	Hope Park		68				14	54
2010/11	£255.31		Memorial seat	Hope Park		11				2	9
09.08.13	£1,223.56		Picnic Benches (x3) - Wooded area	Hope Park	Brown EnviroPool	106				21	85
19.01.17	£1,473.75		Memorial seats (3)	Hope Park	Brown Recycle	247				49	198
15.02.17	£1,170.00		Memorial seats (3)	Hope Park	Brown Recycle	196				39	157

06.03.17	£1,485.00	Memorial seats (3)	Hope Park	Brown Recycle	249				50	199	
02.11.17	£810.00	Memorial seats (2)	Hope Park	Brown Recycle	170				34	136	
03.05.18	£360.00	Memorial seat (1)	Hope Park	Brown Recycle	94				19	75	
24.05.18	£405.00	Memorial seat (1)	Hope Park	Brown Recycle	106				21	85	
01.02.19	£360.00	Memorial seat (1)	Hope Park	Brown Recycle	94				19	75	
17.04.19	£355.00	Memorial seat (1)	Hope Park	Brown Recycle	117				23	94	
15.05.19	£400.00	Memorial seat (1)	Hope Park	Brown Recycle	131				26	105	
16.08.19	£310.00	Memorial seat (1)	Hope Park	Brown Recycle	101				20	81	
23.06.20	£339.00	Manor Brow KCAC Seat	Manor Brow	Brown Recycle	139				28	111	
30.07.20	£1,170.00	Memorial seats (3)	Hope Park	Brown Recycle	479				96	383	
23.09.20	£405.00	Memorial seat (1)	Hope Park	Brown Recycle	166				33	133	
19.10.20	£755.00	Memorial seats (2)	Hope Park	Brown Recycle	309				62	247	
08.12.20	£355.00	Memorial seat (1)	Hope Park	Brown Recycle	146				29	117	
12.03.20	£405.00	Memorial seat (1)	Hope Park	Brown Recycle	166				33	133	
31.03.22	£1,475.00	Memorial seats (4)	Hope Park	Brown Recycle	755				151	604	
31.03.23	£784.00	Memorial seats (2)	Hope Park	Brown Recycle	501				100	401	
31.03.24	£789.50	Memorial seats (2)	Hope Park	Brown Recycle	632				126	506	
31.03.25	£604.50	Memorial seats (1) & plaques (2)	Hope Park	Brown Recycle	0	605			121	484	
	£30,716.62	£0.00									
					5133	605	0	5738	1148	4590	
OFFICE EQUIPMENT											
IT & Premises (Golf Hut, Staff Room, Office & Kiosk) Equipment											
		Disposals during year - Original Cost									
26.08.09	£472.00		CO2 (1) & foam (1) Extinguisher & fire blankets (2)	Golf Hut	17				3	14	
21.02.17	£780.00		Euro Grade 6K Safe	Golf Hut	131				26	105	
23.08.19	£98.70		HP OfficeJet 6950 MFJ Printer	PM Office	32				6	26	
29.04.22	£745.83		HP Probook 450 G8 Core i5 Laptop	PM Office	477				95	382	
	£2,096.53	£0.00									
					657	0	0	657	131	526	
	Total Disposals during year - Original Cost	£12,733.86			TOTAL	518267	29146	3543	543870	18656	525214

Memorial Seats - Physical check made March 2017 - For insurance purposes - In addition to totals above for furniture

2016/17	Actual 40 seats @ £400 each	£16,000.00
2017/18	Additions see above x 2	£800.00
2017/18	Removals x 3	-£120.00
2018/19	Additions see above x 3	£1,125.00
2018/19	Removals x 2	-£720.00
2019/2020	Additions see above x 3	£1,065.00
2019/2020	Removals x 3	-£1,200.00
2020/2021	Additions see above x 9	£3,429.00
2020/2021	Removals x 8	-£3,200.00
2021/2022	Additions see above x 4	£1,475.00
2021/2022	Removals x 4	-£1,200.00
2022/2023	Additions see above x 4	£784.00
2022/2023	Removals x 4	-£800.00
2023/2024	Additions see above x 2	£790.00
2023/2024	Removals x 2	-£800.00
2024/2025	Additions see above x 1	£605.00
2024/2025	Removals x 1	-£400.00
		£17,633.00

Note: cannot be placed on asset register workings as purchased in previous years - Re FHC & CAP 2017